



**NOTES**

- Carefully remove existing ceramic floor tiles & make good disturbed areas, lay approved 600x300mm textured non-slip granitto floor tiles with epoxy tile adhesive and 25mm thick approved.
- Lay a strip of 300mm wide Aluminium strip border
- Fix stain less steel kicking plate size 150mm at base of all wc partitions and doors.
- Replace all existing ceiling lights including emergency lights
- Replace floor traps with approved similar traps (bronze/cast iron).
- Hack off and replace existing wall tiles and replace with 600x300mm approved granitto matt tiles on cement sand backing.
- Make good disturbed areas

New Geberit washbasin tap Brenta, wall-mounted, mains operation, for concealed function box: bright chrome-plated L22cm with mixer on granite vanity top fixed on block board top, steel brackets or similar and approved complete with accessories and infra-red sensors

Granitto wall tiles full height (600x300)mm with Border tiles as per approved sample

Replace all automatic wcs with shower cubicles with Geberit shower channel cleanLine80: L30-90cm stainless steel brushed complete with all accessories

New whb on granite vanity top fixed on block board top, steel brackets or similar and approved complete with accessories and infra-red sensors

18mm full height MDF particle boards to conceal the cisterns with access doors for maintenance as per approved sample

Geberit Duofix element for wall-hung WC, 112 cm, with Sigma concealed cistern 12 cm as per approved sample

18mm full height MDF particle boards to conceal the cisterns with access doors for maintenance as per approved sample

Geberit Duofix element for wall-hung WC, 112 cm, with Sigma concealed cistern 12 cm as per approved sample

Geberit urinal Preda with integrated control, mains operation with automatic cistern and flush system; (Article No.111.300.00.5) & all necessary accessories as per approved sample

Geberit urinal Plastic urinal divider ;white Alpine (Article No.115.202.11.1) as per approved sample

New 600x650mm Footbath foot wash free (Article No.3000) for those of Muslim faith

New Geberit washbasin tap Brenta, wall-mounted, mains operation, for concealed function box: bright chrome-plated L22cm with mixer on granite vanity top fixed on block board top, steel brackets or similar and approved complete with accessories and infra-red sensors

18mm 1800mm height MDF particle boards with 50mm aluminium strip fixed on the tiled floor as per approved sample

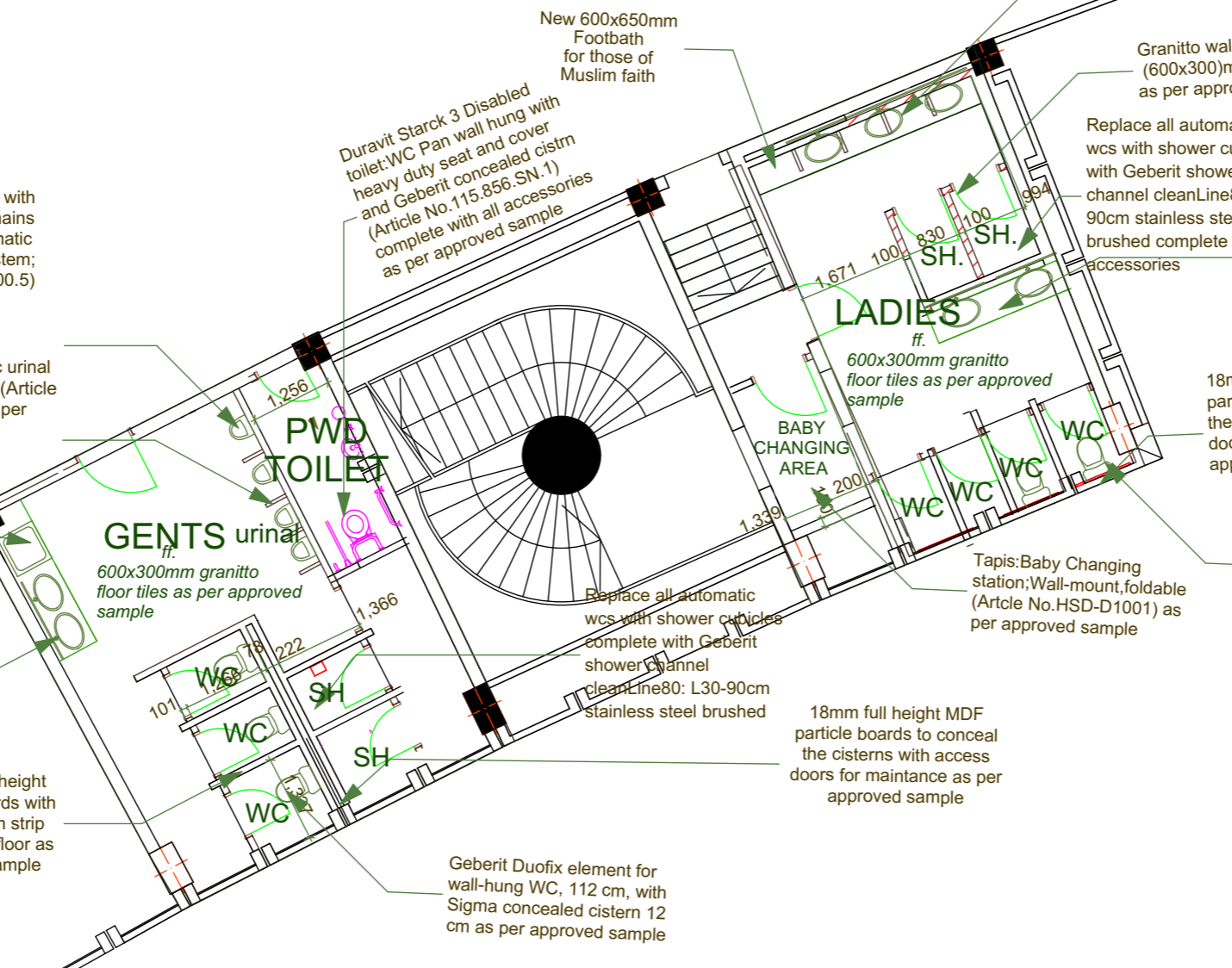

**TYPICAL TOILET BLOCK LAYOUT PLAN**

**1. This drawing is protected by the copyright act and cannot be used or reproduced in part or in whole without author's consent.**

**2. All dimensions in mm unless stated should be read and not measured**

**3. All construction work to comply with latest K.B.S. code of practice Local Authority By- Laws and fire regulations.**

**4. Contractors must verify all dimensions and levels before commencing work, any discrepancies should be reported to the Architect before work is put at hand.**

**5. D.V denotes a permanent ventilation and must be provided above all doors and windows where indicated.**

**6. D.P.C denotes one layer of bitumen felt to be provided under all walls; above 150mm G.L.**

**7. All drainage Road crossing to be incased in concrete to civil engineer's detail.**

P. O. Box 19001-00501 NAIROBI  
Tel: 6611000/6612000  
Fax: 822078  
E.Mall: info@kenyaairports.go.ke

**PROPOSED REFURBISHMENT OF TERMINAL 1B,C-JKIA**

**TYPICAL TOILET BLOCK LAYOUT PLAN**

KAA/OT/JKIA/0092/2019-2020

Arch. W.C.Kalya

Arch. Fred Odawo

General Manager (P&ES).

Dep No. **E001**

Date: **MARCH 2020**

Scale: **1:100**